

Nakamichi®

Nakamichi®

Design and specifications are subject to change without notice.

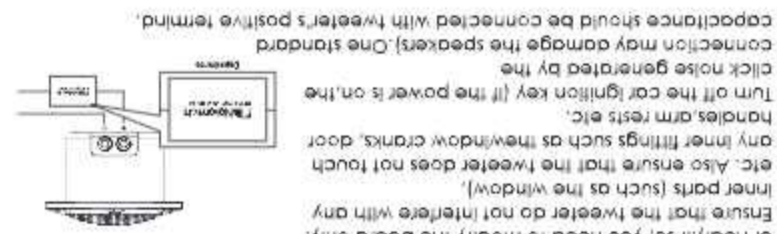
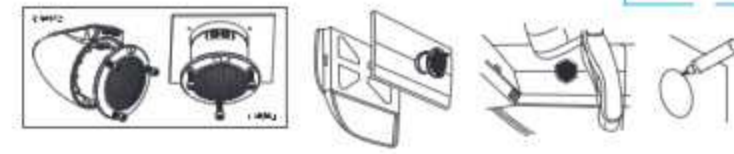

capacitance should be connected with tweeter's positive terminal.  
connector may damage the speaker's positive terminal.  
Turn off the car ignition key if the power is on the  
handles, arm rest, etc.  
Ensure that the tweeter does not interfere with any  
or nearby parts (such as the window cranks, door  
etc.) Also ensure that the tweeter does not touch  
any metal fittings such as the window cranks, door  
handles, arm rest, etc.

Read and understand of instructions before you use the apparatus. If damage is  
caused by failure to follow instructions, the warranty does not apply.  
Use only the supplied mounting hardware for a safe and secure installation.  
Do not continuously use the speaker system beyond the peak power handling  
capacity.  
Keep credit cards, watches, recorded tapes etc. with magnetic coding away  
from the speaker system to prevent damage caused by the magnets in the  
speakers.  
Clean the apparatus with soft, damp cloth. Never use substances such as  
alcohol, chemicals or household cleaners on the apparatus.

What's in the box.

- ① Tweeter (x2pc)
- ② Tweeter's Back Cover (x2pc)
- ③ Capacitor (x2pc)
- ④ 2.5mm "L" Type Wrench (x1pc)
- ⑤ Mounting Screw Mx10mm (x6pc)

Important

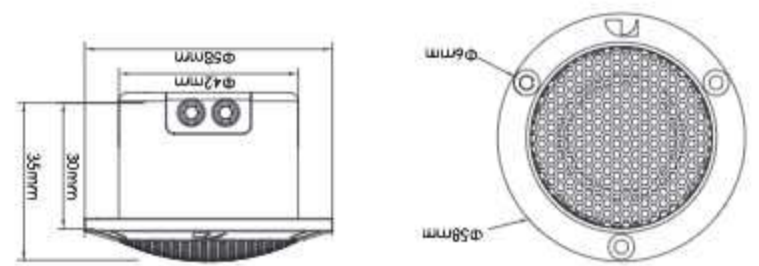

Dimensions (Unit:mm)

**Specifications**  
Type: 25mm ASV Tweeter System  
N power: 20 watts  
Peak Power: 160 watts  
Sensitivity (dB/W/m): 89.3 dB  
Nominal Impedance: 4 ohms  
Frequency Range: 800Hz-20k Hz  
Voice Coil: ASV 25 mm  
Magnet Size: 0.43 Oz (12.2g)  
Mounting Depth: 30 mm  
Mounting Diameter: 42 mm

Installation

Mount on DOOR (FRONT OR REAR)  
You can mount tweeter on the front door or rear tray of your car.  
Make sure that nothing obstructs around the mounting location of the door.  
A hole for mounting may already be cut of the inner panel of the door (front  
or rear). If so, you need to modify the board with only  
Ensure that the tweeter do not interfere with any  
parts (such as the window cranks, door  
etc.) Also ensure that the tweeter does not touch  
any metal fittings such as the window cranks, door  
handles, arm rest, etc.

NS-QT25  
25mm ASV Tweeter System-N-Power 160W

Nakamichi®

Nakamichi®

COMPETITION  
SERIES

NS SERIES

25mm ASV Tweeter System  
N-POWER 160W

PEAK  
POWER: 160W

NS-QT25



Since  
1948  
JAPANESE  
INNOVATION

Nakamichi®

nakamichicarudio.com

NS SERIES

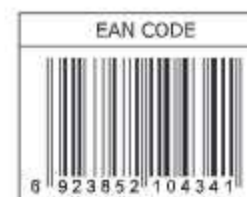

图号: NS-QT25-CH02  
彩盒尺寸: L248\*W152\*H82  
注: 尺寸为内尺寸, 实线为刀模线, 虚线为压线!